

Truss Reinforcement

BL-30 Truss Reinforcement

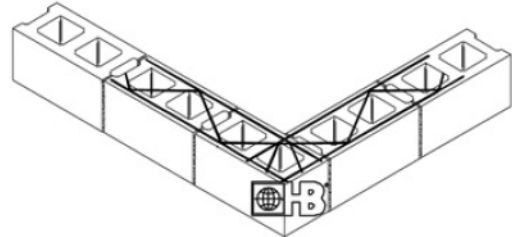

Prefabricated Corner

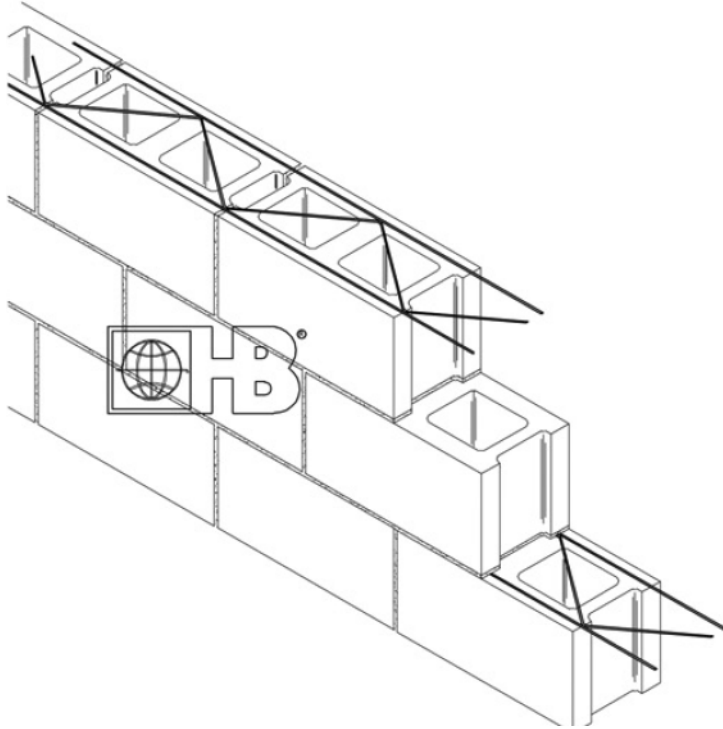
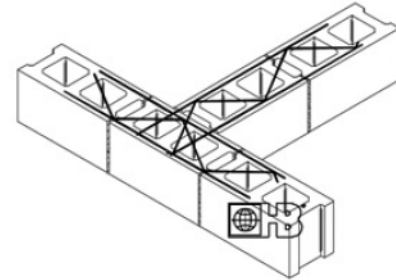

Prefabricated Tee

DRAWINGS FOR ILLUSTRATIVE PURPOSES ONLY

Material Conformance - Joint Reinforcement

Blok-Lok joint reinforcement products conform to ASTM C951, ACI 530 for joint reinforcement, CSA standard A370.

Wire: (Carbon Steel): Prefabricated construction from cold-drawn steel wire conforming to ASTM A 82:

Tensile Strength - 80,000 p.s.i.

Yield Point - 70,000 p.s.i. minimum

Wire Diameter:

9 gauge (.148" or W1.7)

3/16" (.187" or W2.8)

Side Rods and Cross Rods available in any combination of the above.

Cross Rods welded 16" O.C.

First Cross Rods welded 12" in from each end to allow lap splices per code requirements.

Blok-Lok manufactures steel wire products from a minimum of 95% post-consumer recycled material.

Finishes:

- ☐ Mill Galvanized coating: ASTM A 641 (0.1 oz/ft²)
- ☐ Hot-Dip Galvanized after fabrication: ASTM A 153 (1.5 oz/ft²)
- ☐ Stainless Steel: ASTM A 580 - AISI Type 304 (Type 316 available on special order).

Note: Blok-Lok recommends Stainless Steel for maximum protection against corrosion.

Wire Size:

- ☐ (S) Standard Weight:
9 Gauge Side Rods x 9 Gauge Cross Rods
- ☐ (EH) Extra Heavy:
3/16" Side Rods x 9 Gauge Cross Rods
- ☐ (SHD) Super Heavy Duty:
3/16" Side Rods x 3/16" Cross Rods

Block Size:

- | | | | |
|------------------------------|------------------------------|------------------------------|------------------------------|
| <input type="checkbox"/> 4" | <input type="checkbox"/> 6" | <input type="checkbox"/> 8" | <input type="checkbox"/> 10" |
| <input type="checkbox"/> 12" | <input type="checkbox"/> 14" | <input type="checkbox"/> 16" | |

Note: For Corner or Tee, state width of block walls.