

S-5!®

The Right Way!



Why Snow Retention?

When snow accumulations begin to melt, the result can be catastrophic as the blanket of snow avalanches off the roof dumping tons of snow onto anything in its path. It can damage landscape, gutters, adjacent roofs, vehicles, and cause injury or death to passers-by. SnoRail™/SnoFence™ dramatically reduce these risks associated with rooftop avalanches, maintaining the clean lines of the roof and lasting as long as the roof itself! SnoRail™/SnoFence™ can be designed and engineered on a site-specific basis.

Whether aluminum or brass, our SnoRail™/SnoFence™ system offers a sleek, stylish design. Utilizing patented S-5!™ seam-clamping technology, this snow retention system doesn't pierce the metal roofing, thereby protecting roof coatings and weather-tightness warranties.

Why SnoRail™/SnoFence™?

Architects and roof designers agree: the clean lines, cylindrical shapes and high-tech look of our SnoRail™ and SnoFence™ systems present an attractive solution to snow retention problems! They function without cluttering the lines of the roof. With up to six times the strength of adhesively mounted devices, and without the high labor costs and inconsistencies of soldered snow guards, S-5!® offers the perfect, long term, dependable solution for traditional standing seam and sheet copper roofing. The SnoRail™ and SnoFence™ systems are mechanically attached with patented S-5!® clamps utilizing our patented round-point setscrews—designed not to “pin” or “fix” the roof panels to the building, leaving thermal movement unrestricted. The clamps are precision-machined from aircraft quality, high tensile aluminum—not cast or plastic. All related hardware is non-ferrous, compatible stainless steel for lasting performance.

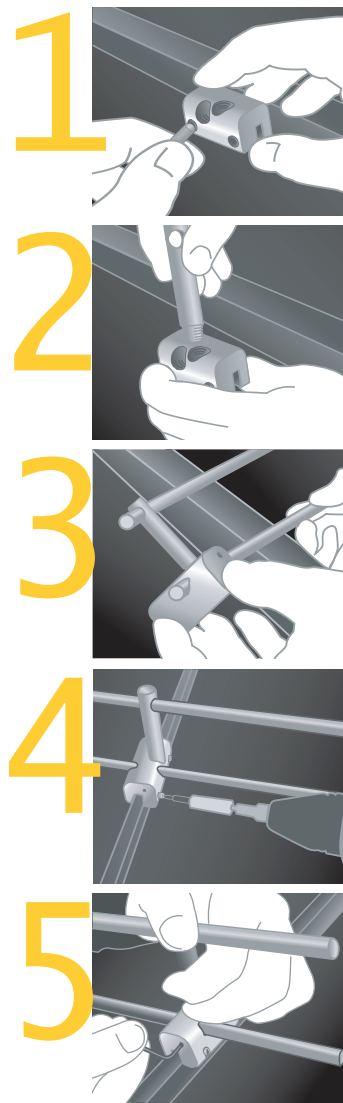

Attach almost **anything** to standing seam metal roofs without piercing the panel!

888-825-3432

www.S-5.com

SnoRail™/SnoFence™ — Aluminum & Brass

SnoRail™/SnoFence™

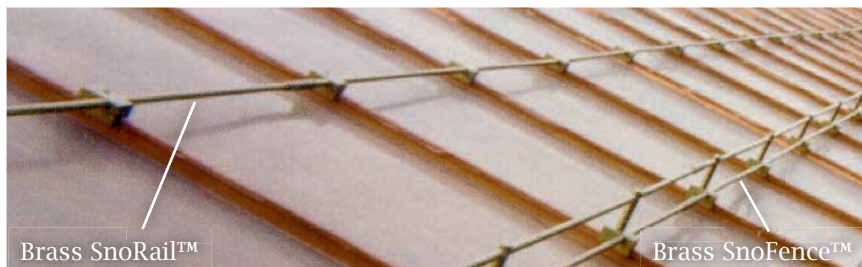

The SnoRail™/SnoFence™ system is available in brass for use on copper batten or standing seam roofs and in aluminum for other standing seam roofing materials. SnoRod™ is available in brass or stainless. SnoPost™ is available in brass and stainless.



SnoRail™

One SnoRod™ is inserted through the S-5-ASF or S-5-BSF clamps, positioning it just above the panel seams. The resulting assembly is called SnoRail™.



SnoFence™

Thread the SnoPost™ into the clamp to provide for the addition of a second SnoRod™, about 2" above the first. The resulting assembly is called a SnoFence™.

Installation is easy: The S-5!® clamp mechanically attaches to the panel seam by inserting and tightening our patented round-point setscrews to the specified tension (see www.S-5.com). These screws will slightly dimple the seam material, but not pierce it. Our patented clamps offer durability unequalled by chemical bonds and adhesives that degrade with time and exposure.



The extraordinary strength of the SnoRail™/SnoFence™ system is in the S-5!® clamps. Our patented round-point setscrews will slightly dimple the metal seam material but will not puncture it.

S-5!® Warning! Please use this product responsibly!

Products are protected by multiple U.S. and foreign patents. Visit the website at www.S-5.com for complete information on patents and trademarks. For maximum holding strength, setscrews should be tensioned and re-tensioned as the seam material compresses. Clamp setscrew tension should be verified using a calibrated torque wrench between 160 and 180 inch pounds when used on 22ga steel and between 130 and 150 inch pounds for all other metals and thinner gauges of steel. Consult the S-5!® website at www.S-5.com for published data regarding holding strength.

Copyright 2009, Metal Roof Innovations, Ltd. S-5!® products are patented by Metal Roof Innovations, Ltd.

version 121509

Distributed by